

THE

ICON

LONDON

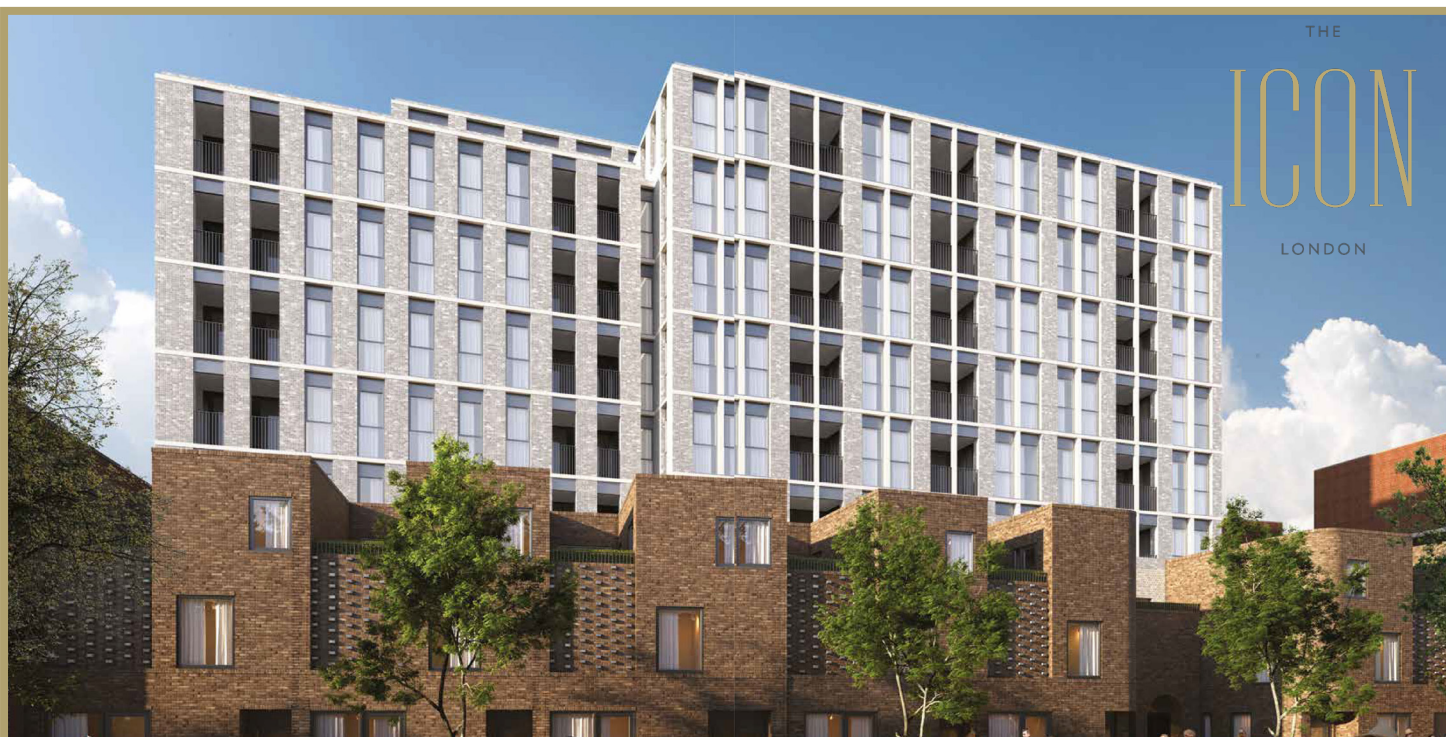

DEVELOPMENT KEY FEATURES

PRICE £363,800 - £695,500

VENDOR Dominus New Homes

TENURE 250 Year Leasehold

LOCAL AUTHORITY Haringey

EST COMPLETION Q3 2023

UNIT MIX 1, 2 & 3 apartments

SERVICE CHARGE £982 - £2,022 Per Annum

WARRANTY Buildzone

PAYMENT TERMS

£2,000 Reservation fee

15% Deposit due on exchange (**28 days**)

85% Balance on completion

VENDORS SOLICITOR

COMPANY Morr & Co LLP

FAO Christopher Zahner

ADDRESS 12 Station Road West, Oxted, Surrey, RH8 9ES

MAIN TEL 01883 723712

DIRECT TEL 01883 338046

RECOMMENDED SOLICITOR

COMPANY Quastels LLP

FAO Jonathan Neilan

ADDRESS 54 Baker Street
London W1U 7BU

DIRECT TEL 020 7908 2533

MOBILE 07931 360727

TRAVEL CONNECTIONS

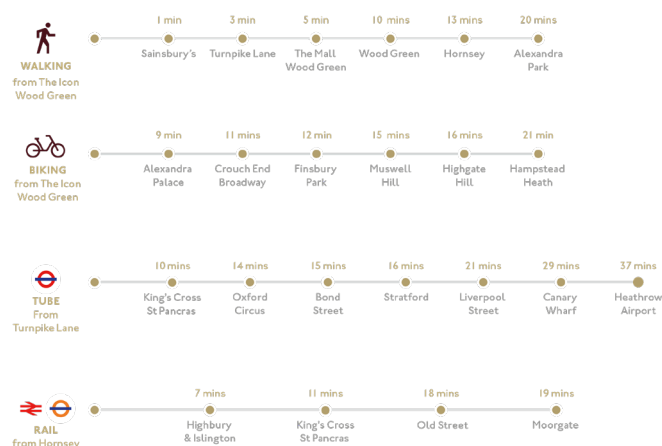

HIGH ROAD LONDON N22 6BX

THE DEVELOPMENT OVERVIEW



The Icon Wood Green is a new state-of-the-art complex in N22, within easy reach of the city, the West End and beyond.

This stunning collection of 99 studios, 1,2,3-bedroom apartments & penthouses is situated on the High Road which makes grabbing a coffee or a bite to eat after work in one of the great local eateries a breeze.

SET IN
THE HEART
OF WOOD
GREEN

FANTASIC
TRANSPORT
LINKS

ABUNDANCE
OF STUNNING
AMENITIES

DEVELOPMENT FACILITIES

The apartments have a luxury bespoke interior and include integrated appliances, stone worktops, on trend engineered wood flooring, chic bathrooms, and stylish kitchens all handpicked to create a home with an enviable finish. All apartments benefit from private outside space and buyers also have access to the stylish communal terraces, so you can make the most of this fabulous setting, perfect for you to invite your friends over and enjoy on those warm summer evenings. For convenience and connectivity, you can be at Turnpike Lane underground station in three minutes on foot and from there you can access the whole of the capital with ease.

- ✓ **STYLISH SPECIFICATION**
- ✓ **LANDSCAPED COMMUNAL**
- ✓ **GARDEN & ROOF TERRACES**
- ✓ **PRIVATE BALCONIES/TERRACES**
- ✓ **BUILDINGWIDE**
- ✓ **CCTV COVERAGE**
- ✓ **SECURE CYCLE STORAGE**
- ✓ **10-YEAR BUILDING WARRANTY**
- ✓ **DEVELOPER DEFECT PERIOD***
- ✓ **VIDEO ENTRY SYSTEM**

